



Teralux Smart Doorlock Biosecure X6 User Manual



Teralux Office

Komp. Ruko Harmoni Mas, Jl. Jemb. Dua Raya
No.15 blok A, RT.1/RW.3, Pejagalan, Penjaringan,
North Jakarta City, Jakarta 14450

Teralux Smart Doorlock Biosecure X6

For residential, office, community and other places of security & modern management needs, We launched a face (optional) + fingerprint + swipe card + password + graffiti + Wi-Fi remote video intercom and other functions of the automatic intelligent door lock.

Features

Power on self test with intelligent identification and quick selection.

Features virtual password anti-peeping, automatic capture, anti-pry alarm, and anti-cat eye lock.

Includes doorbell, one-touch lock/unlock, combination unlocking, and remote control.

Made from high-quality components for reliability and tested for durability in harsh environments.

A variety of reasonable functions, simple and easy to remember operation, remote unlocking, efficient and convenient

Assembly Diagram

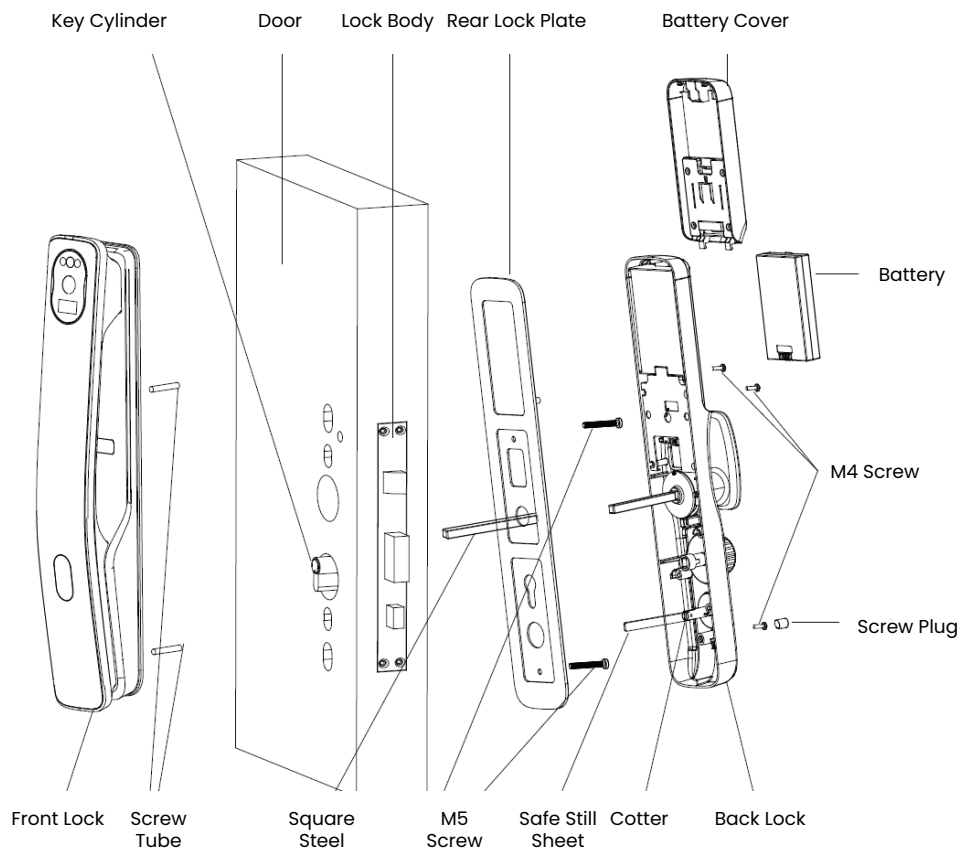

Technical Parameter

Parameter	Specification
Number of open door faces/fingerprints/card	100+
Number of door opening codes	50+
Fingerprint Sensitivity	1.2 Times
Capture Fingerprint resolution	500DPI
Stereo Sampling	360 Degree
Power Supply	Built-in 5000mAh Rechargeable Battery
Wireless Protocol	Wi-Fi
Mechanical Key	Keyhole & USB Charging Port

Function Introduction

Face recognition for door opening

Input face: Follow voice prompts to look directly at the camera, then slightly to the left, right, and bow your head to record corresponding movements.

Password-authenticated door opening

Operation: Touch the key area to light up the keyboard, enter the password, and press OK. The door lock will open automatically after verification.

Virtual password voyeurism function: You can input any numbers before and after the correct password to unlock, protecting your code from being seen.

Induction card swipe to open the door

Operation: Use the encrypted sensor card to approach the card area. The door opens after successful verification.

Fingerprint verification of door opening

Operation: Touch the fingerprint scanner to verify. The door lock automatically opens upon successful verification.

Remote video door to door

Operation: Touch the key area to light up the keyboard and press the doorbell key.

App Integration: The mobile APP receives a remote door opening request; you can then press the lock for remote unlocking and use the phone intercom key for video intercom functions.

Emergency key opening

Operation: If the door lock does not open automatically, you can use the emergency key to unlock it.

System Operating Instructions

Starting up The system is in experience mode, and any face or fingerprint can be unlocked.

Initialize Use a needle to press the setting key of the back lock for a long time, or press the unlocking and locking keys of the back lock at the same time for about 3 seconds. The system will pop up a prompt box to restore factory Settings. Click Yes (#) and the system will initialize all Settings. Do nothing or click no (*) to return.

Menu operations

Touch the keyboard area, light the keyboard, and the system starts. Click the * button and then click the button to enter the system Settings menu.

Main Menu Settings Click # to enter the main menu Settings. If the system administrator is empty, enter the initial password (123456) to enter the menu directly.

Parameter	One Level Menu	Secondary Menu	Remark
Admin Setting	Add user	FP&PWD&IC	
		Add Face	Opention
	Delete User	Enter User	
	Factory Reset	*ESC #Enter	
	Sensor Settins	1. Hi 2. Mid 3. Low 4. Turn off	Opention
User Setting	Add User	FP&PWD&IC	
		Add Face	Opention
	Delete User	Enter User	
	Network Setting	1. Turn on 2. Turn off	
System Setting	Set Date Time		
	Unlock Mode	a	
	Doorlock set	1. Lock Back[2S] 2. Auto Lock[off]	
		3. Alarm Set[off] 4. Card Set[on]	
	Volume Setting	1. System vol 06 2. Bell vol 06	Press the number key

Note: The hidden menu must be without school administrators operate * + # key version information (777) (888 to open the door direction [left - right] motor torque setting intelligent lock motor torque of high, medium and low three gears).

Multi Language Setting

Enter the corresponding shortcut key, press # to confirm initialization, and switch languages.

Language	Shortcut Key	Language	Shortcut Key
Chinese	5556668801	Korean	5556668809
Portuguese	5556668802	Thai	5556668810
English	5556668803	Indonesia	5556668811
spanish	5556668804	French	5556668812
Russian	5556668805	German	5556668813
Arabic	5556668806	Vietnamese	5556668808

Operating Instructions

Unlocking The Door

3D Face Recognition: Simply walk up to the door. The lock will automatically sense your presence, recognize your face, and unlock.

Fingerprint: Place your registered finger on the fingerprint sensor. The external breathing light will illuminate, and the lock will unlock quickly (recognition speed <0.5s).

Password: Enter your registered password on the password key panel, then press '#' or the confirmation key.

IC Card: Present your registered IC card to the IC card area on the lock.

Mechanical Key: In case of emergency or power failure, insert the mechanical key into the mechanical keyhole and turn to unlock.

APP Remote Unlock: Open the Tuya Smart Life APP, select your lock, and tap the "Unlock" button.

Alexa Voice Unlock: If integrated with Alexa, say "Alexa, unlock the [your lock's name]" and provide your 4-digit voice password when prompted.

Locking The Door

Automatic Locking: The lock is designed to automatically lock after a set period once the door is closed.

One-Key Locking: Press the "one key to locking" button on the keypad.

APP Remote Lock: Open the Tuya Smart Life APP, select your lock, and tap the "Lock" button.

Alexa Voice Lock: If integrated with Alexa, say "Alexa, lock the [your lock's name]".

Video Intercom and Monitoring

Doorbell Function: When a visitor presses the doorbell button on the lock, it will initiate a video call to your Tuya Smart Life APP.

Two-Way Communication: Through the app, you can see and speak to the visitor in real-time.

Real-time Monitoring: You can access the lock's camera feed at any time via the Tuya Smart Life APP for live monitoring.

Network Pairing via Tuya App

After the Door Lock is connected to mains power, Once the light is blinking, open the Tuya app and follow the on-screen instructions to complete pairing.

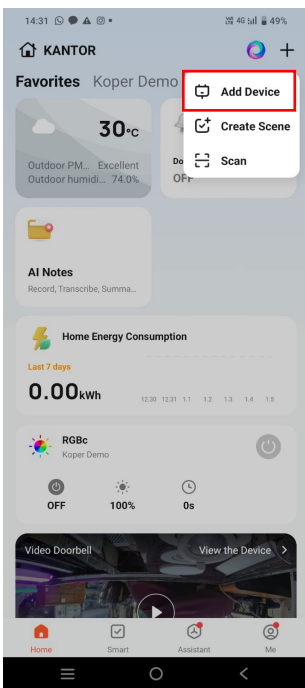

Add Device

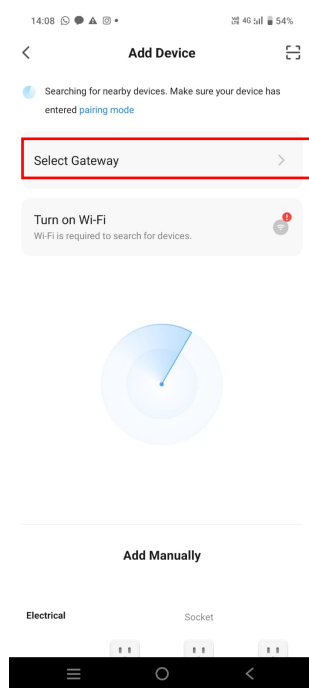

Select Nearby Gateway

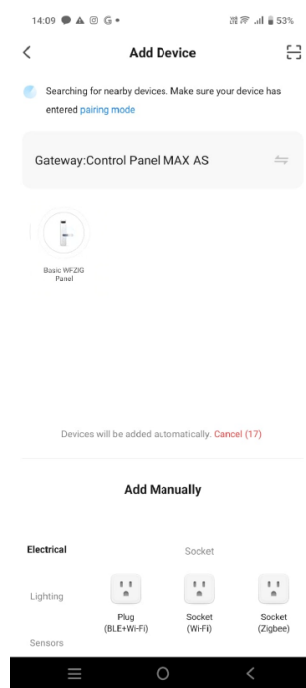

Nearby Device Detected

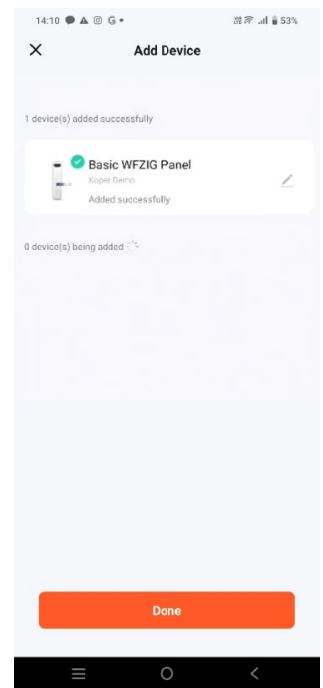

Rename and Done



Teralux Office

Komp. Ruko Harmoni Mas, Jl. Jemb. Dua Raya
No.15 blok A, RT.1/RW.3, Pejagalan, Penjaringan,
North Jakarta City, Jakarta 14450

teraluxliving.com