

# Teralux Pulse Wall Switch User Manual

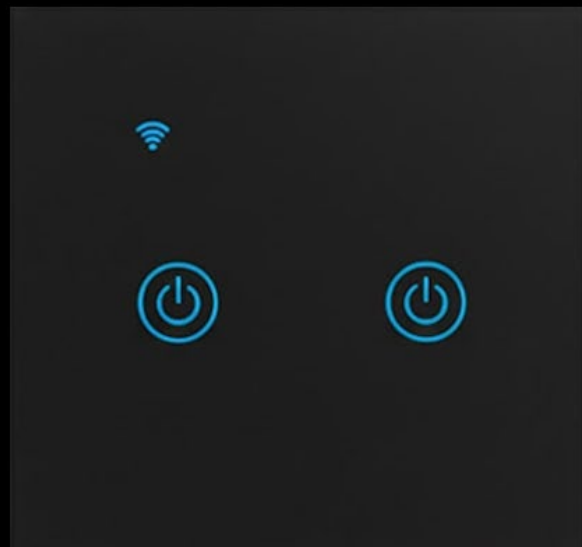
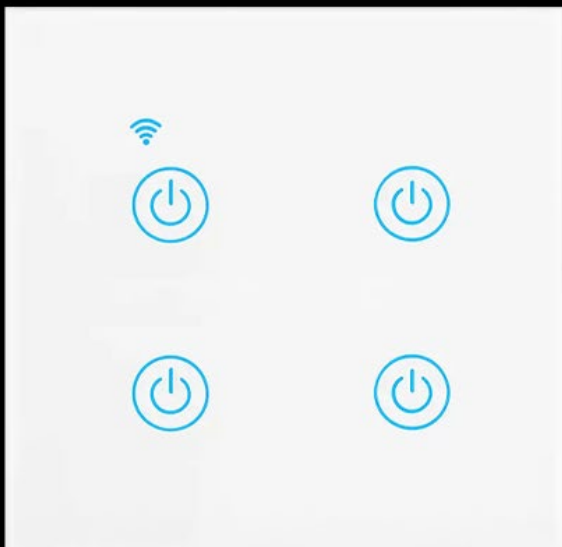

**Teralux Office**

Komp. Ruko Harmoni Mas, Jl. Jemb. Dua Raya  
No.15 blok A, RT.1/RW.3, Pejagalan, Penjaringan,  
North Jakarta City, Jakarta 14450

## Teralux Smart Doorbell Proview

TERALUX Smart Wall Switch is a modern touch-panel switch designed to control lighting and other smart home devices through the Smart Life or Tuya app. Available in both Zigbee and Wi-Fi variants, it integrates seamlessly into a wide range of smart home ecosystems. Its capacitive touch panel offers precise responsiveness and a sleek, elegant appearance, making it suitable for both residential and commercial installations.

### Features

Manage lights and connected devices directly from the Smart Life or Tuya app anytime, anywhere.

Choose Zigbee or Wi-Fi versions to match your smart home setup and ensure smooth integration.

Capacitive touch surface delivers faster, more accurate responses with a clean, premium look.

Supports schedules, timers, and automation scenes to simplify daily routines.

Compatible with Alexa and Google Assistant for hands-free switching and convenience.

Designed for residential or commercial use with a minimalist style that fits most interiors.

### Dimension & Attributes

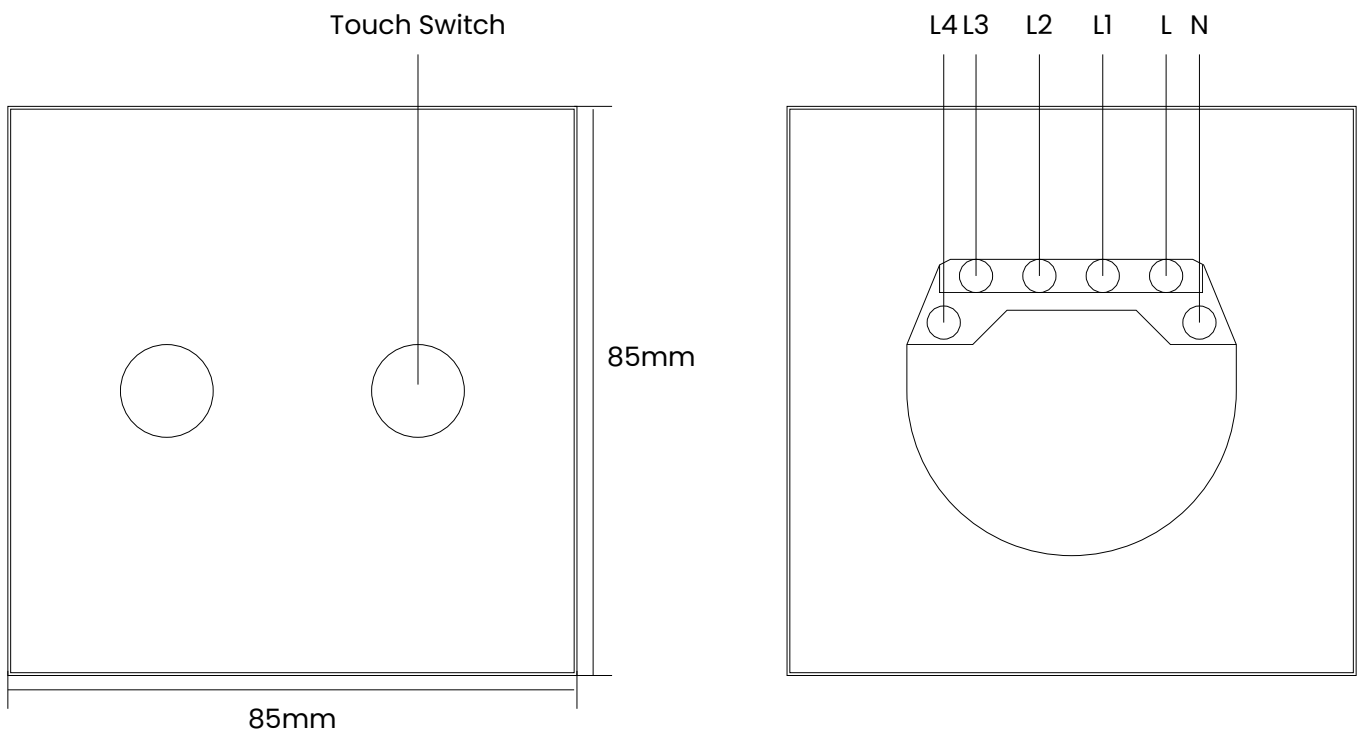

# Technical Parameter

## Parameter

## Specification

Input Voltage	110–240V AC, 50/60 Hz
Wireless Protocol	Zigbee / Wifi
Interface	Capacitive Touch Panel
Control Method	Remote control via mobile app
Functions	Lighting control and smart home device integration

## Wiring Diagram

The diagram shows how to connect the smart touch switch to four lighting loads (L1–L4). Each load wire is connected to its corresponding output terminal, while the live wire (L) feeds power into the switch. The neutral wire (N) connects from the power source to the switch and continues to each light. LED indicators show the line, load, and neutral connections for easy installation.

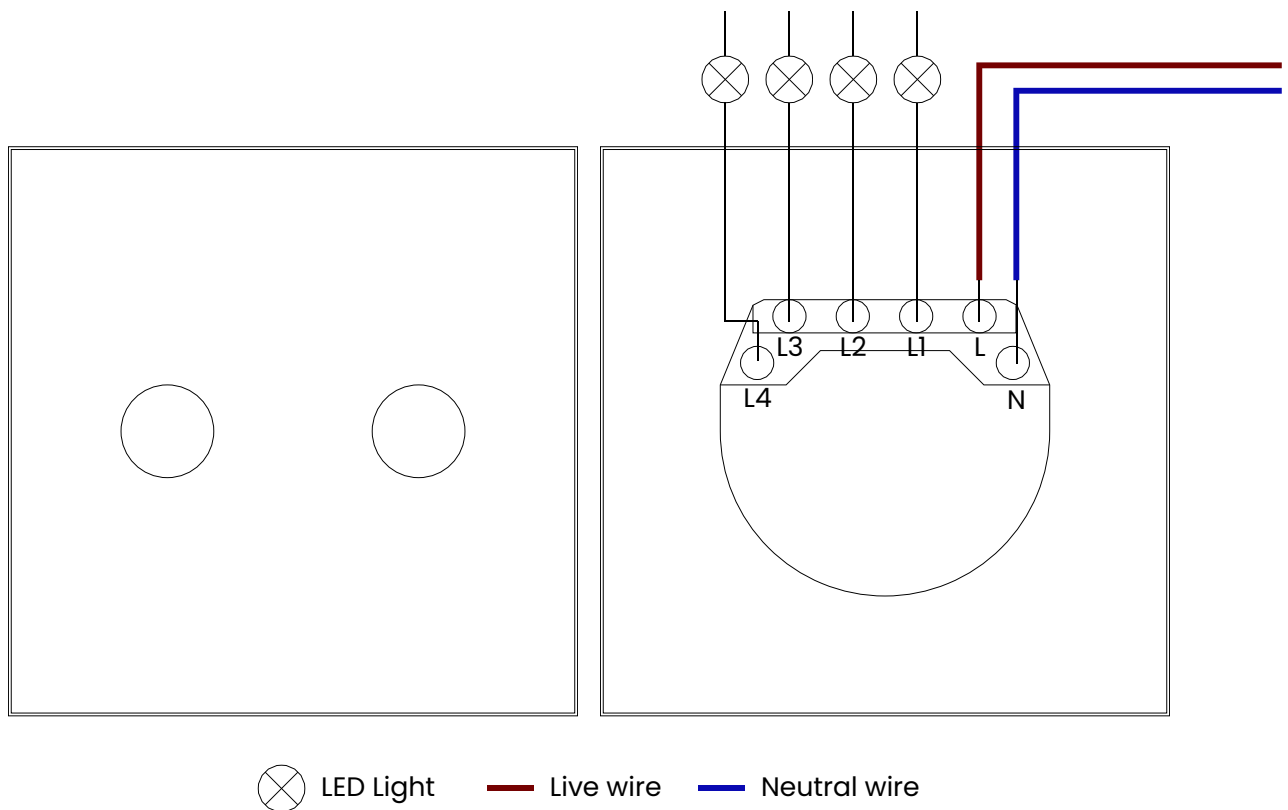

# System Diagram

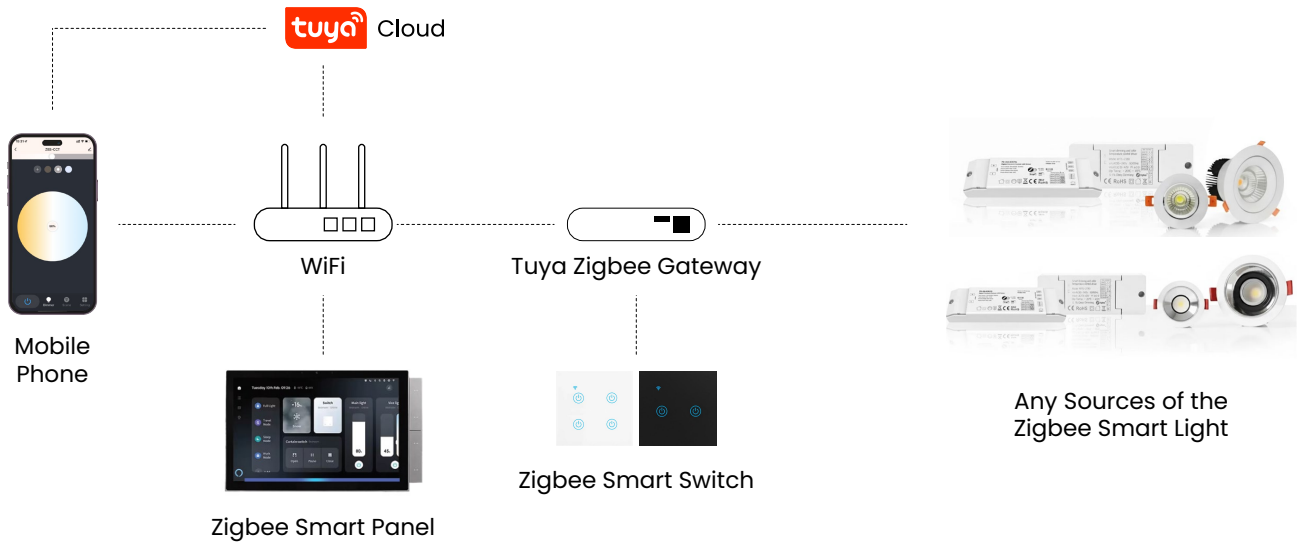

# Pairing Instruction

After the Pulse Wall Switch is connected to power, the indicator will start blinking to show it has entered pairing mode. Open the Tuya app, tap the (+) button to add a new device, then select Nearby Gateway. The Pulse Wall Switch will automatically be detected as a smart device and is ready to use.

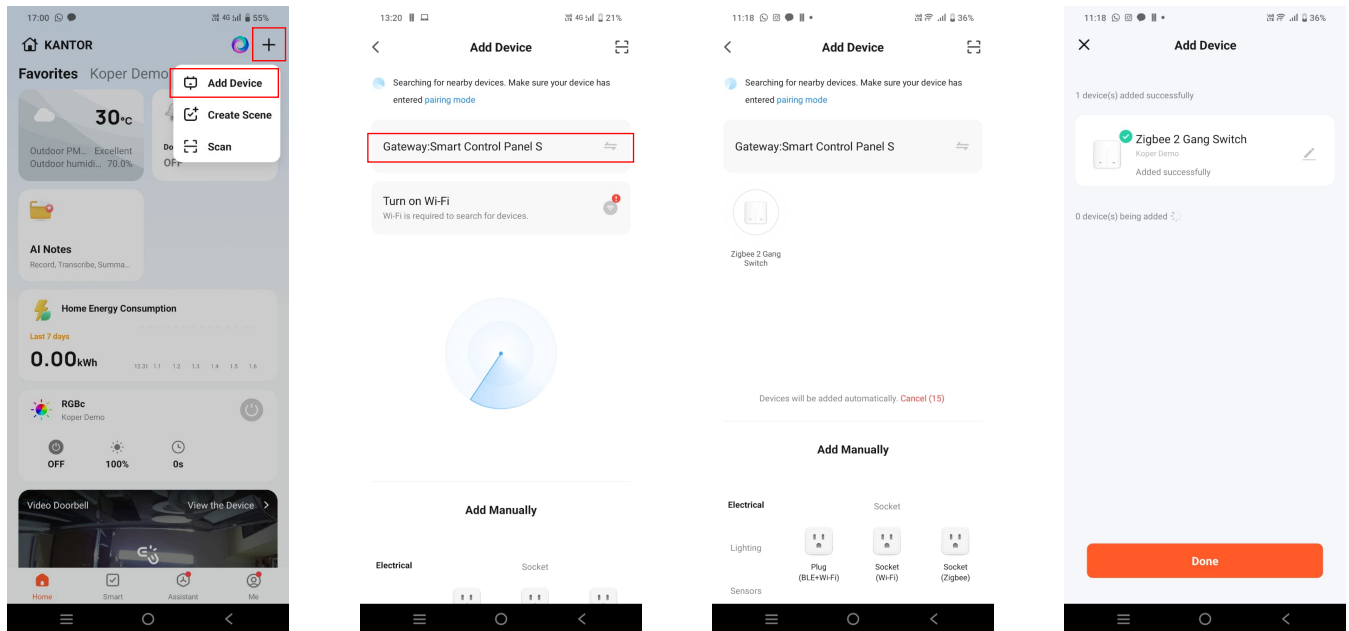

Add New Device

Select Gateway

Nearby Device Detected

Device Ready

# System Function

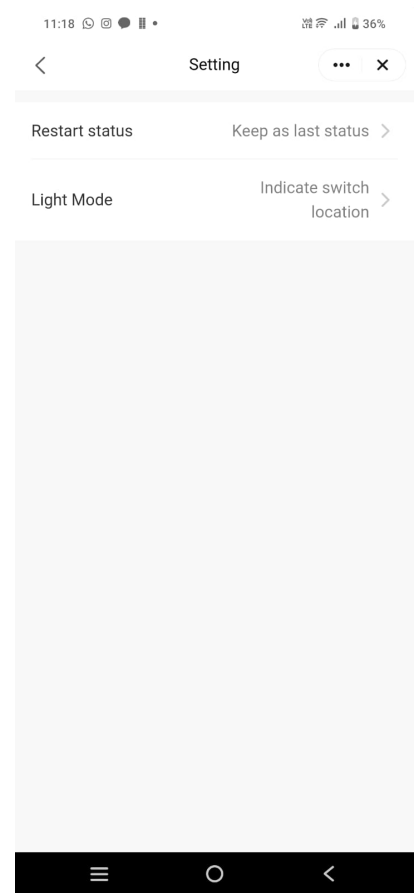
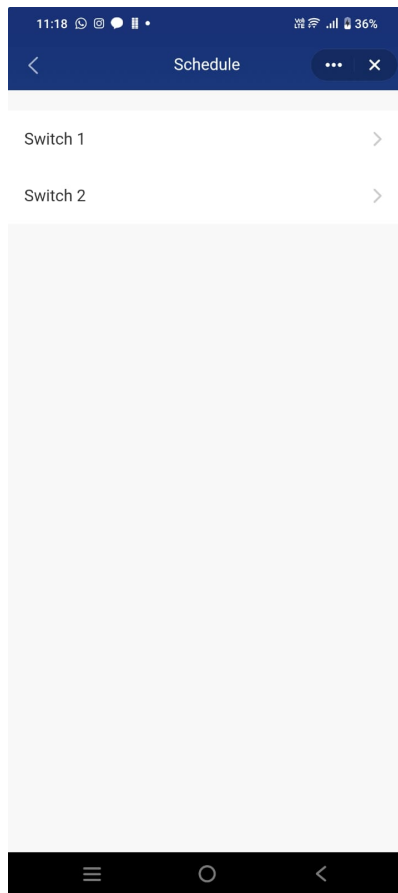
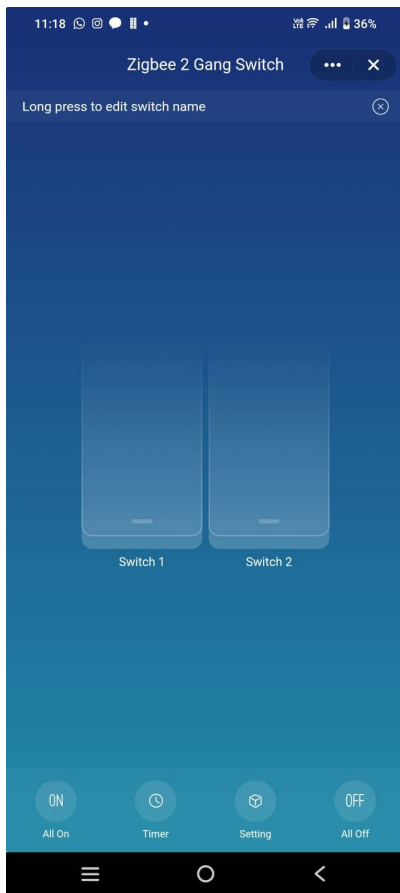



**Teralux Office**

Komp. Ruko Harmoni Mas, Jl. Jemb. Dua Raya  
No.15 blok A, RT.1/RW.3, Pejagalan, Penjaringan,  
North Jakarta City, Jakarta 14450

[teraluxliving.com](http://teraluxliving.com)